



Fifteen-channel Remote Control 8101-15 Passport

1. Purpose

Remote Control is designed to control remotely the executive devices of the Radio series, as well as executive devices of the Nero series (only with static code) using transcoder Nero 836 1 UPM.

2. Specifications

Operating frequency range, MHz.....	433,05–434,79
Maximum power of emitted signal, not more than, MW.....	10
Number of control channels.....	15
Number of devices for feedback mode (one per channel).....	15
Battery type (number of pieces)	CR2032 (2)
Battery voltage, V.....	3
Overall dimensions, mm.....	129×40×15
Operation temperature range, °C.....	from 0 to +40
Degree of frame protection.....	IP40

3. Peculiarities

- transmission of control commands with static or dynamic code. Factory setting – dynamic code;
- 15 control channels plus shared channels for each group and one shared for all groups. Shared channels are not available for programming, they are intended for device management;
- **operation mode* with improved dynamic code and feedback support.**

This mode is necessary for visual confirmation of remote control commands. If the device does not respond to the command, the remote control reports an error with three beeps and three flashes of the corresponding channel indicator. If the command is executed successfully, there are no instructions.

*Remote control operation modes:

- 1 - static;
- 2 - dynamic;
- 3 - improved dynamic (default settings);
- 4 - improved dynamic with feedback.

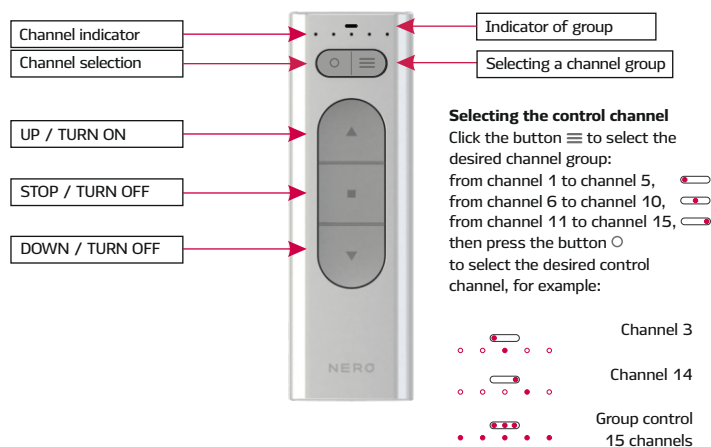

Fig. 1 — Assigning remote control buttons and selecting the control channel

4. Programming

Action	Indication
Recording the remote control channel into the memory of the executive device	
<ol style="list-style-type: none"> 1. Input the executive device in the programming mode (see manual for the corresponding device). 2. Select a recorded channel. 3. Record a channel: <ol style="list-style-type: none"> a) in dynamic mode: press the «STOP» button and, without releasing it, briefly press the «UP» button, then release both. b) in static mode: briefly press the «STOP» button. c) in dynamic mode with feedback: <ul style="list-style-type: none"> - press the «STOP» and «UP» buttons simultaneously; - release the «UP» button without releasing the «STOP» button - get a signal from the remote about successful recording to the device. 	<p>Confirmation of record on the executive device depends on the programming type and mode: short-long-short green flash on the indicator or long-term movement «DOWN», short-term «UP-DOWN» movement and long-term «UP» movement of the roller shutter.</p> <p>Remote display in dynamic mode with feedback:</p> <ul style="list-style-type: none"> - channel recorded: 1 beep and 1 flashing diode of the recorded channel; - channel not recorded: 3 beeps and 3 flashing diodes of the recorded channel.
Changing the remote control code: selection of dynamic or static code	
<ol style="list-style-type: none"> 1. Enter the «remote control mode Selection» menu: press and hold the «STOP» button for more than 4 seconds. 2. Select the desired mode by short pressing the «UP» or down buttons. 3. Exit the menu: press and hold the «STOP» button for more than 1 second. The remote control will also automatically exit the menu after 8 seconds. 	<ol style="list-style-type: none"> 1. All channel indicators start blinking. 2. Number of flashes of the remote control indicator: <ul style="list-style-type: none"> 1 flash — static mode; 2 flashes — dynamic operation mode; 3 flashes — improved dynamic mode; 4 flashes — improved dynamic mode of operation with feedback.
Delete the remote control channel from the memory of the executive device	
<ol style="list-style-type: none"> 1. Input the executive device in the programming mode (see manual for the corresponding device). 2. Select a deleted channel. 3. Delete a channel: <ol style="list-style-type: none"> a) in dynamic mode: press the «STOP» button and without releasing it, briefly press the «DOWN» button, release both. b) in static mode: press and hold the «STOP» button for more than 1 second, then release; c) in dynamic mode with feedback: <ul style="list-style-type: none"> -press simultaneously button «STOP» and «DOWN» button; -release the «DOWN» button while holding down the «STOP» button. 	<p>Confirmation of deletion on the executive device depends on the programming type and mode: one long-term red flash or long-term «DOWN-UP» movement of the roller shutter.</p> <p>Remote display in dynamic mode with feedback:</p> <ul style="list-style-type: none"> - channel deleted: 2 beeps and 2 flashing diodes of the channel being deleted; - channel not deleted: 3 beeps and 3 flashing diodes of the deleted channel(see the instructions on the remote control) in red.
Calibration (removing devices that did not respond to the remote control in feedback mode)	
<p>When you calibrate the remote control, all channels are cleared of devices that did not respond to the remote request.</p> <p>Calibrate the remote control: press the «DOWN» and «UP» buttons simultaneously, release any of them after the first beep, and press it again. Hold the buttons until you get a response from the remote control (but no more than 8 seconds).</p>	<p>Information from the remote control:</p> <p>3 beeps and 3 flashes of all indicators.</p>
Opening / closing control channels	
<ol style="list-style-type: none"> 1. Enter the menu for closing / opening channels: press and hold the channel selection button for more than 4 seconds. 2. Select the desired channel by short pressing the channel selection button. 3. <ol style="list-style-type: none"> a) Close the channel: press the «DOWN» button. b) Open a channel: press the «UP» button. 4. Exit the channel opening/closing menu — automatically after 5 seconds. 	<ol style="list-style-type: none"> 1. 4 remote control channel indicators are lit (all except the first one). 2. The indicator for the selected channel is not lit. 3. Indication: <ol style="list-style-type: none"> a) channel closed: 3 short flashes; b) channel open: 1 long flash.



5. Distance Programming Mode (DPM)

DPM is not available for static and feedback mode!

Action	Indication
DPM. The remote control should be programmed previously in the executive device	
1. Enter the DPM with the pre-programmed remote control: press the «STOP» button of the recorded channel and, while holding it, press the «UP» button. Hold both buttons for more than 4 seconds, then release them and briefly press the up button twice for 5 seconds. 2. After entering the DPM, you can perform the following actions: a) record the channels of new remotes to the device memory; b) delete channels of recorded remotes from device memory; c) erase all device memory: press the «STOP» and «DOWN» buttons of the recorded remote channel simultaneously, hold them for more than 4 seconds; d) output the device from the DPM: press and hold the «STOP» button of the recorded channel of the remote control, then briefly press the «UP» button.	1. Roller shutter curtain will make a short-term movement «DOWN-UP» once, and after 5 sec. by repeated short-term movement «DOWN-UP» it will confirm the input in the DPM. 2. Indication on the executive device: a) Roller shutter curtain will make long-term movement «DOWN», short-term movement «UP-DOWN», and long-term movement «UP». b) Roller shutter curtain will make long-term movement «DOWN-UP». c) Roller shutter curtain will make long-term movement «DOWN-UP» twice. d) Roller shutter curtain will make short-term movement «DOWN-UP» twice.

6. Updating the remote control

The 8101-5 remote control can receive new updates if you have an online 8767 device. You must log in on your 8767 device. The update is only available in the feedback mode.

Action	Indication
 The battery of the remote control must be charged, otherwise the update will not be installed (error alarm).	
1. Simultaneously press and hold the «UP» and «DOWN» buttons until the second channel led lights up and the second beep sounds, then release both buttons. 2. In the app, add the remote control and activate the update download.	1. The indicators of all channels, from the 1st to the 5th, start flashing in waves. 2. The indicators continue to flash until the update is installed, and then turn off.
 The remote control is updated within 10 minutes, forced interruption is available by the "stop" button.	

7. Current maintenance

If during operation the device fault is detected it is necessary to call maintenance personnel. Within the warranty period servicing and repair are provided by the manufacturer dealer.

8. Storage, transportation, service life

Products should be stored in packaging at temperatures from + 5°C to + 40°C and relative air humidity of no more than 80% in heated and naturally ventilated warehouses, in air-conditioned warehouses in the absence of aggressive impurities, conductive dust, acid fumes and alkalis, as well as gases that cause corrosion and destroy insulation. During storage, sharp fluctuations in temperature (more than 3°C/min) and air humidity (more than 5%/min) are not allowed.

Products must be transported in package in containers, closed railway cars, heated sealed compartments of aircraft and holds, as well as automobile transport with protection against precipitation at any distance at temperatures from -50°C to + 50°C, and with relative humidity up to 100% - at 25°C. When transporting products, protection from dust and atmospherical condensation should be provided.

The average product life is at least 5 years.

9. Disposal

At the end of the service life the device is subject to disposal. The device does not pose a hazard to human health and environment. The device does not contain any non-ferrous and precious metals. Waste batteries should be disposed separately from mini remote controls.

10. Manufacturer's warranty

Guaranteed storage life is 6 months from the manufacturing date (the last 6 figures in the product serial number, for example: 191120 – November 19, 2020).

Guarantee service life is 24 months from the date of sale.

With the note of sale absent – from the manufacturing date.

Warranty obligations cease in case of non-observance of operating conditions established by the manufacturer and mechanical damage during operation. Warranty obligations do not cover the case of failure to present the device passport.

13. Potential problems

Problem	Probable reason	Fault elimination
The remote control is not recorded in the executive devices.	1. Battery has run down (LED is off or blinks when you press the remote control). 2. The remote control in dynamic mode is not recorded in the executive devices which support only static transmissions.	1. Change battery. 2. Change the operation mode from dynamic to static one.

11. Completeness

Remote Control Radio 8101-15..... 1 pc.
 Passport 1 pc.
 Individual packing 1 pc.

12. Acceptance certificate

Remote Control Radio 8101-15 (see serial number on the first page) is manufactured in conformance with RB TR 808001034.012-2018, is approved by QCD and is classified as fit for operation.

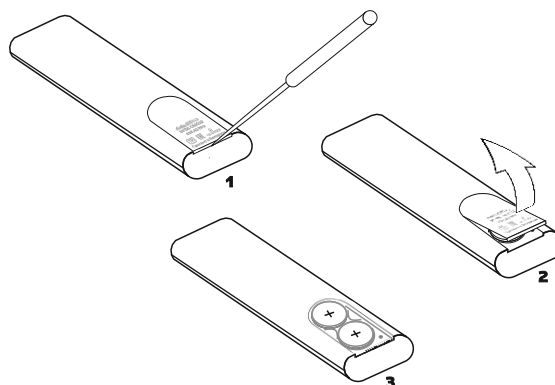

Fig. 2 — Replacing batteries



Manufacturer and representative office in Belarus

Nero Electronics LLC
 Minsk FEZ, 223016, Minsk district,
 Novy Dvor Rural Council, 74
 Tel.: +375 17 388-53-00
 +375 29 609-25-59
 by-order@neroelectronics.by
 www.neroelectronics.by
 technical support:
 +375 29 610-12-53

Representative offices in Russian Federation:

SketchNero Group LLC
 15, Bolshaya Ochakovskaya St.,
 119361, Moscow.
 Tel.: +7 495 430-79-60
 +7 495 735-64-47
 info@nerosk.ru

 technical support:
 8 800 5000-930

Nero SPb LLC
 14, Komsomola St., Build. 2,
 195009, St. Petersburg
 Tel.: +7 812 987-51-56
 +7 981 757-90-45
 spb-order@neroelectronics.by

 technical support:
 8 800 5000-930

Representative office in Ukraine:

Umnye resheniya LLC
 21, B. Khvoyki St., Office ,
 03022, Kiev.
 Tel.: +38 067 679-51-22
 +38 044 500-18-55
 ua-order@neroelectronics.by

 technical support:
 +380 67 679-51-22